

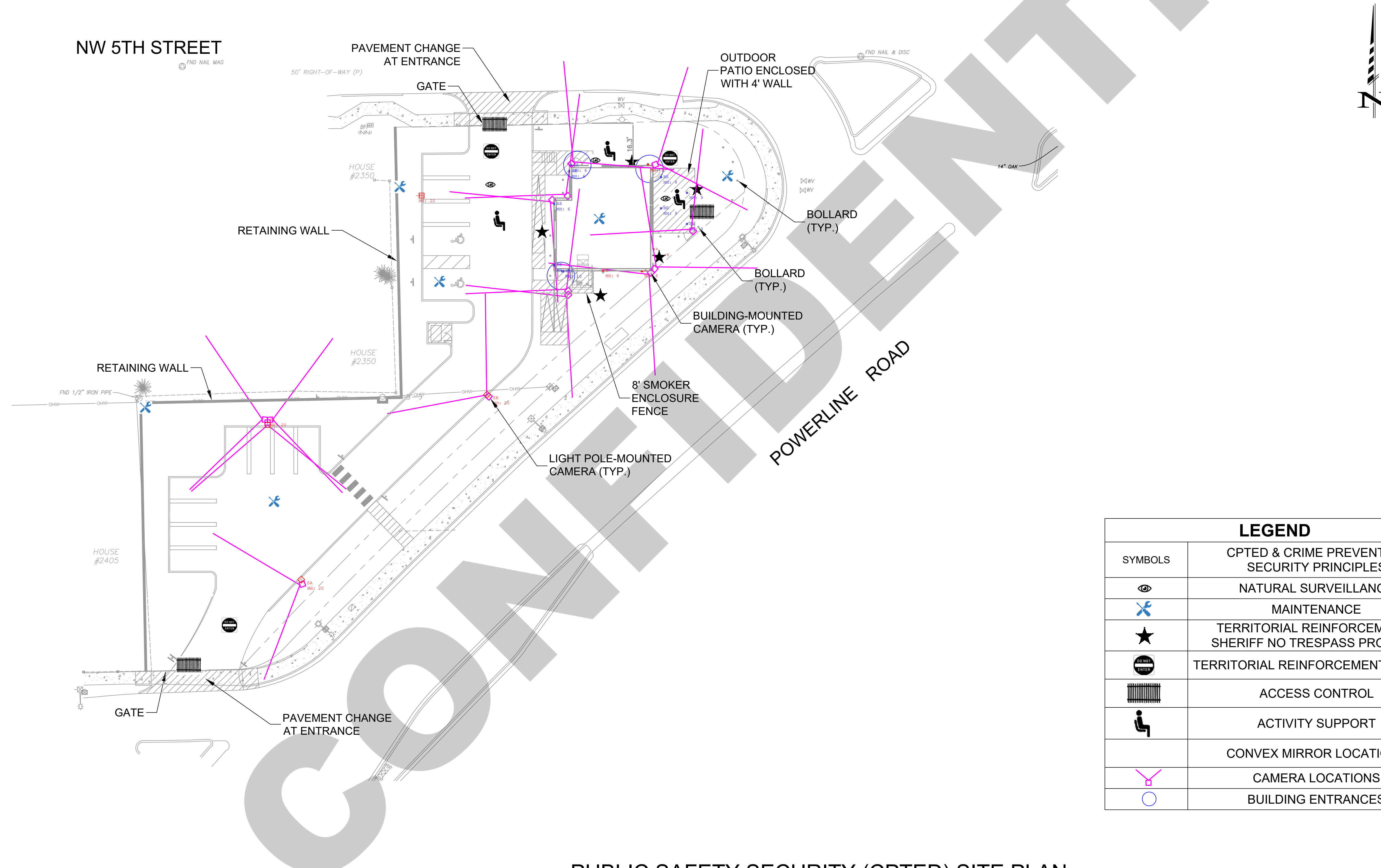

It is understood that SAFETY AND SECURITY REVIEWS do not guarantee a crime will never occur; it is an effort to mitigate opportunities for crime and to help avoid any present and future security deficiencies, conflicts, threats, breaches, or liabilities that might occur without any review. It is further understood that all comments made by the Broward Sheriff's Office regarding this plan are preliminary only, as additional SECURITY STRENGTHENING AND CPTED attributes may be required as development progresses.

When a Broward Sheriff's Office CPTED Practitioner is required to assist in an inspection of the project during the Certificate of Completion &/or Certificate of Occupancy Application Phase, Security Strengthening & CPTED measures that have not been adequately addressed will still be required to ensure the safety & wellbeing of the employees, residents, tenants, visitors & all legitimate users of the site.



# PUBLIC SAFETY SECURITY (CPTED) SITE PLAN

|     |                   |           |
|-----|-------------------|-----------|
|     |                   |           |
|     |                   |           |
| 2   | DRC SUBMITTAL     | 8/25/2025 |
| 1   | PRE-APP SUBMITTAL | 4/17/2025 |
| No. | Revision/Issue    | Date      |



**PLANW3ST**

10152 INDIANTOWN RD.  
# 159  
JUPITER, FL 33478  
954-529-9417  
planw3st.com

Project Name and Address

BIG TREE BBO  
N POWERLINE RD  
POMPANO BEACH FL 33069

|         |           |                   |
|---------|-----------|-------------------|
| Project | 2023-051  | Sheet<br><br>PS-1 |
| Date    | 4/17/2025 |                   |
| Scale   | 20'       |                   |

**DRC**